



7106S

**Adaptadores de cuadrado de 1/2"
para punta hexagonal de 5/16"**



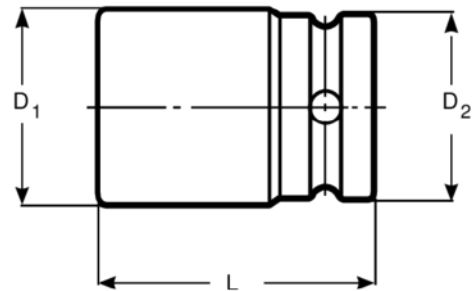

DETALLES DEL PRODUCTO

- Acabado pulido fino.
- Acero aleado de alto rendimiento
- Adecuado para puntas de 5/16"
- Normas: ISO 1174 y DIN 3121
- Embalaje en blíster



ATRIBUTOS DE PRODUCTO

Producto			L	D1	D2	 g
8174A	5/16 in		40 mm	16,5 mm	22,2 mm	60 g

Follow the Fish!

